

## LED Street Light - SB05 Series

Part No.# SB05-300N-D-50-T3

### Description

This Street / Shoebox light is perfect for Area Lighting, and good for medium height round lot poles and new construction applications in industrial, road ways, seaside areas, outdoor applications. Also, it is UL certificated with high quality and 5 years warranty. Also, it's DLC 5.1 Premium listed, you will get higher rebate from DLC.

### Features & Benefits

- Unique design with appropriate heat fins, that dissipate heat to maximize the life of this fixture
- Standard exposed 1-10V dimming leads and Sosen brand driver
- The driver chamber cover Clamshell design
- Reliable quality at the best price
- Replaces Up To 950W PSMH
- UL/cUL, DLC 5.1 Premium Listed



### Specifications

|                    |            |
|--------------------|------------|
| Input Wattage      | 300W       |
| Input Voltage      | 120-277VAC |
| Efficacy           | 150LM/W    |
| Lumens             | 45000LM    |
| Driver Brand       | Sosen      |
| CCT                | 5000K      |
| CRI                | Ra>70      |
| THD                | <20%       |
| Frequency          | 50/60Hz    |
| Power Factor       | ≥0.95      |
| LED Type           | 2835       |
| LED Quantity       | 480PCS     |
| Light Distribution | Type III   |

|                       |                                 |
|-----------------------|---------------------------------|
| Lens Material         | UV stabilized polycarbonate     |
| Housing               | Die-cast Aluminum               |
| Operating Temperature | -40°F to 104°F (-40°C to +40°C) |
| Storage Temperature   | -40°F to 194°F (-40°C to +90°C) |
| Operating Humidity    | 10%-90% RH                      |
| Storage Humidity      | 10%-95% RH                      |
| Surge Protection      | L/N-PE: 10KV, L-N: 6KV          |
| Finish                | Bronze                          |
| Additional function   | 1-10V dimmable                  |
| Life Time             | > 50,000Hrs (Ta=30°C@L80)       |
| Warranty              | 5 Years                         |
| Waterproof Rating     | WET (IP65)                      |
| IK Degree             | IK08                            |
| Certificates          | UL/cUL, DLC 5.1 Premium         |

## Photometric Data

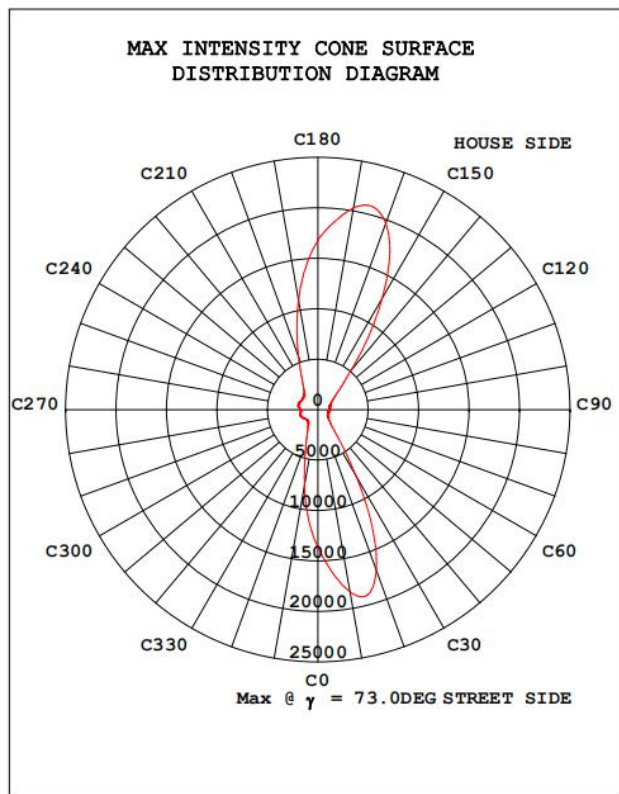
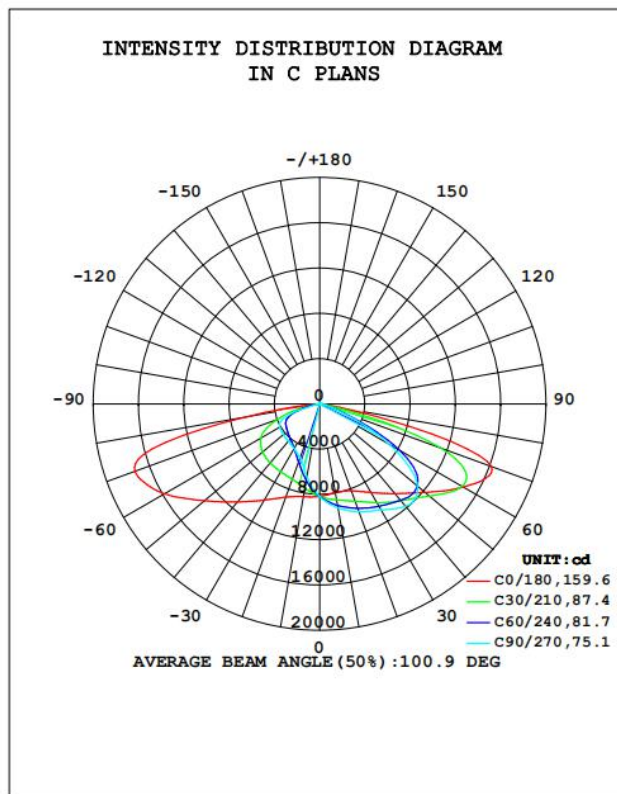

### Model# SB05-300N-D-50-T3

- 26ft mounting height
- IES Classification Type 3

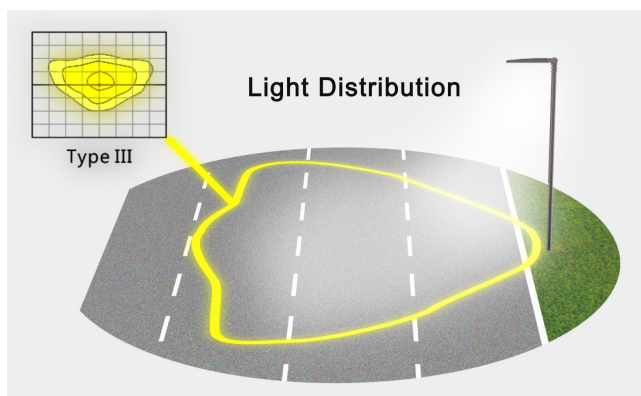

### Recommended use for

- Parking Lots
- Road Ways
- General Area Lighting
- Pathway/Walkways
- Shopping Centers
- Outdoor Courts & Fields

Product Dimension

| Model Number      | Length                    | Width  | Height |
|-------------------|---------------------------|--------|--------|
| SB05-300N-D-50-T3 | 29.56"                    | 12.87" | 2.28"  |
| Slip Fitter Mount | Max Inner Diameter: 2.55" |        |        |

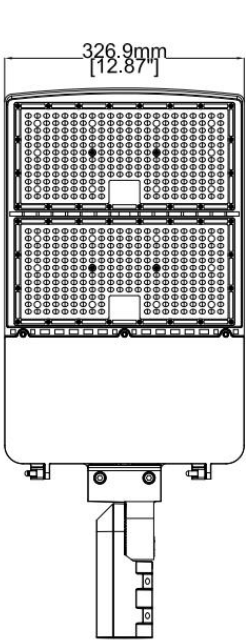

Fixture

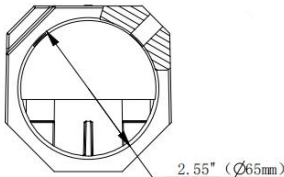
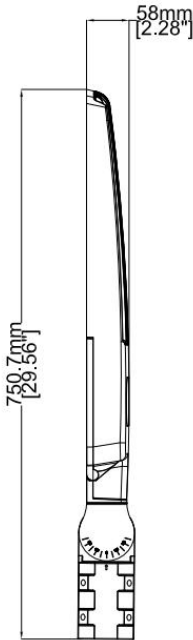

Bracket

Packing Review

| Model Number      | Carton Size            | Net Weight | Grow Weight |
|-------------------|------------------------|------------|-------------|
| SB05-300N-D-50-T3 | 32.1" X 14.57" X 5.52" | 15.65lbs   | 17.65lbs    |

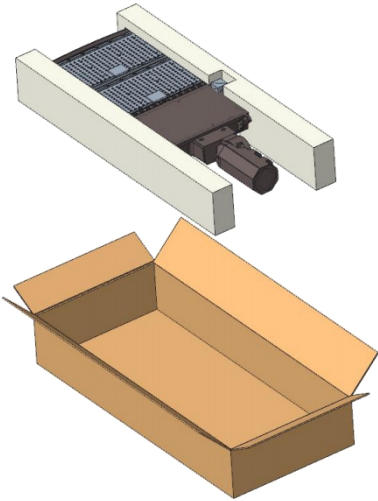
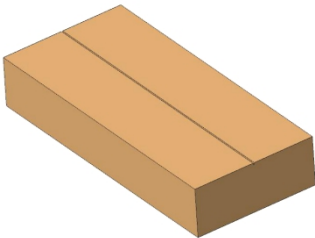

## Installation Steps

### Step 1

Connect the AC wire, and then insert the arm of the slim fitter to the round pole.

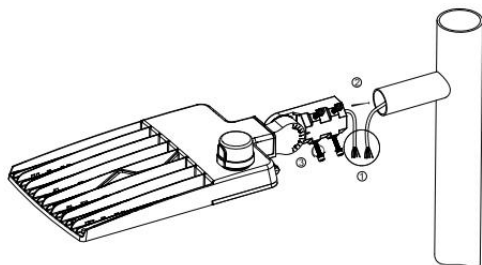

### Step 2

Tighten the screws on the sides of the arm and then power on.

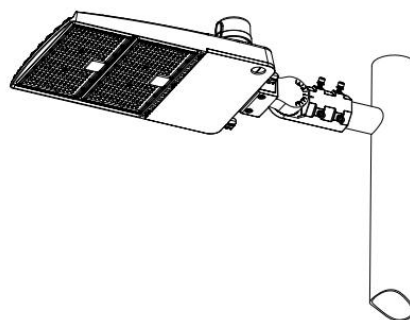

### Note:

The slip fitter mount can be installed with 2-3/8" O.D. pole.

The installed angle can be adjusted MAXIMUM TILT 45°, please do not intend for use as an uplight.

## NOTICE FOR USER

- ☞ Please turn off power before install or change assembly parts.
- ☞ The input voltage and lamps should be matched, after connecting the power line, please make sure the wiring section is insulated.
- ☞ No-professionals, must not install and disassemble the lamps.

## TROUBLE SHOOTINGS

| Trouble                 | Check Points   |
|-------------------------|--|
| Flickering of the light | Turn off the power and turn on again in 3 minutes.<br>If same phenomena occur, then call agencies. |
| Out of working          | Please check the connection.   |